

Outer shell	: Brass (UNS C38500)	Chrome plated (FS-QQ-C-320B)
Latch sleeve	: Special brass	Chrome plated (FS-QQ-C-320B)
Inner shell	: Brass (UNS C38500)	Nickel plated (FS-QQ-N-290A)
Collet nut	: Brass (UNS C38500)	Chrome plated (FS-QQ-C-320B)
Oversize collet sleeve	: Brass (UNS C38500)	Chrome plated (FS-QQ-C-320B)
Insulators	: PTFE	-
Male contact	: Brass (UNS C38500)	Gold plated (ISO 4523)
Clip	: Bronze (UNS C54400)	Nickel plated (FS-QQ-N-290A)
Gland	: Silicone (SI)	-
Other metallic parts	: Brass (UNS C38500)	Nickel plated (FS-QQ-N-290A)
O-ring	: Silicone (MVQ)	-

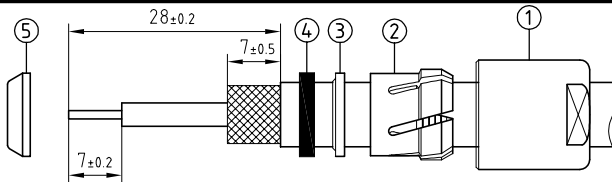

1. Strip the cable according to the given dimensions . (The end of the cable jacket must be cut properly) . Slide it into the collet nut①, the collet②, the ring③, the gland④and the earthing cone⑤.

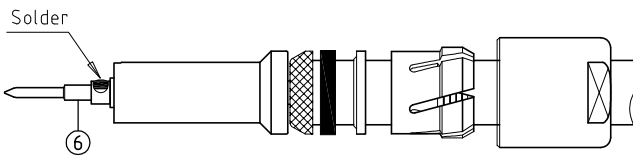

2. In case of a screened cable , fold screen back over the extremity of the earthing cone . Fit the conductor into the subassembly with contact⑥until the insulating sleeve touche the dielectric and one can see the conductor in the contact hole and solder.

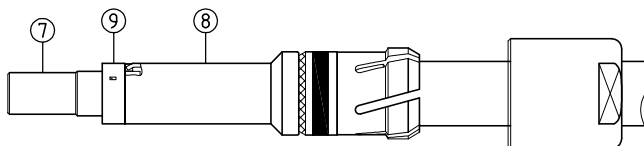

3. Slide the subassembly insulator⑦onto the contact , locate the center-piece⑧of the split insert carrier over the shoulder and key on the insert metal ring⑨. Push the earthing cone against the center-piece whilst checking that the screen is being clamped around the whole circumference and cut , if necessary , the excess screen . Push the gland , the ring and collet against the earthing cone . Push the cable forward and verify that cable jacket is located under the gland .

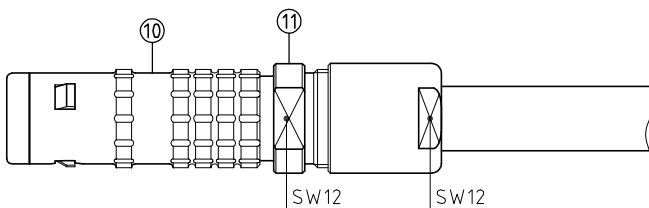

4. Next slide the plug shell⑩fitted with the oversize collet⑪over the insulator assembly making . Screw the collet nut with the appropriate tool and tighten to the maximum torque value of 2Nm .

Flat spanners set : DCP.91.023.TN
 Assembly plier : DPF.91.001.TA

Straight plug , with oversize cable collet .
Series 1E , coaxial (75Ω)

Echelle	Dessiné	05.04.2013	OVU /JPBA
	Contrôle	30.01.2014	JPBA/ATVI
Modif.	01	30.01.2014/ OVU	

ETUDE N° E10429



CH-1024 Ecublens

FFA.1E.275.CTAK _ _